



**COMMERCIAL**



# COMMERCIAL



COMMERCIAL							KEY
<b>METRIC HEX BOLT &amp; NUT</b>  <b>KBH46GCM</b> HDG AS 1111.1 CLASS 4.6	<b>METRIC HEX BOLT &amp; NUT</b>  <b>KBH46ZCM</b> Z/P AS 1111.1 CLASS 4.6	<b>METRIC HEX BOLT &amp; NUT</b>  <b>KBH46PCM</b> PLN AS 1111.1 CLASS 4.6	<b>BSW HEX BOLT &amp; NUT</b>  <b>KBHMSGW</b> HDG AS 2451 MILD STEEL	<b>BSW HEX BOLT &amp; NUT</b>  <b>KBHMSZW</b> Z/P AS 2451 MILD STEEL	<b>METRIC LONG THREAD ASSEMBLED</b>  <b>KBX46GCM</b> HDG AS 1111.1 CLASS 4.6	<b>N/P</b> NICKEL PLATED <b>CHR</b> CHROME <b>BRASS</b> BRASS <b>PLN</b> PLAIN <b>Z/P</b> ZINC PLATED (RoHS COMPLIANT) <b>ZYP</b> ZINC YELLOW PASSIVATE <b>ZP BLK</b> ZINC BLACK PASSIVATE <b>HDG</b> HOT DIP GALVANISED <b>MGAL</b> MECHANICAL GALVANISED	
<b>METRIC HEX BOLT</b>  <b>BH46ZCM</b> Z/P AS 1111.1 CLASS 4.6	<b>BSW HEX BOLT</b>  <b>BHMSZW</b> Z/P AS 2451 MILD STEEL	<b>BSW HEX BOLT</b>  <b>BHMSPW</b> PLN AS 2451 MILD STEEL	<b>METRIC HEX SET SCREW</b>  <b>BS46GCM</b> HDG AS 1111.2 CLASS 4.6	<b>METRIC HEX SET SCREW</b>  <b>BS46ZCM</b> Z/P AS 1111.2 CLASS 4.6	<b>METRIC HEX SET SCREW</b>  <b>BS46PCM</b> PLN AS 1111.2 CLASS 4.6		
<b>BSW HEX SET SCREW</b>  <b>BSMSZW</b> Z/P AS 2451 MILD STEEL	<b>NEW METRIC HEX SET SCREW</b>  <b>BSBRPCM</b> BRASS AS1110.2	<b>METRIC CUP HEAD BOLT &amp; NUT</b>  <b>KBC46GCM</b> HDG AS 1390 CLASS 4.6	<b>METRIC CUP HEAD BOLT &amp; NUT</b>  <b>KBC46ZCM</b> Z/P AS 1390 CLASS 4.6	<b>METRIC CUP HEAD BOLT &amp; NUT</b>  <b>KBC46PCM</b> PLN AS 1390 CLASS 4.6	<b>BSW CUP HEAD BOLT &amp; NUT</b>  <b>KBCMSZW</b> Z/P AS 2451 MILD STEEL		<b>HEX WASHER HEAD POLE STEP STEEL</b>  <b>KBW58GCM</b> HDG HEC CLASS 5.8
<b>METRIC HEX COACH SCREW</b>  <b>BH46GLM</b> HDG AS 1393 CLASS 4.6	<b>METRIC HEX COACH SCREW</b>  <b>BH46ZLM</b> Z/P AS 1393 CLASS 4.6	<b>NEW METRIC FLANGED HEX BOLT</b> SERRATED  <b>BF46ZCM</b> Z/P HEC 1665 CLASS 4.6	<b>METRIC METAL THREAD PAN PHILLIPS</b>  <b>MSMSZPPM</b> Z/P AS 1427:1996 MILD STEEL	<b>METRIC METAL THREAD PAN PHILLIPS</b>  <b>MSMSVPPM</b> ZP BLK AS 1427:1996 MILD STEEL	<b>NEW METRIC METAL THREAD PAN POZI</b>  <b>MSMSZPZM</b> Z/P AS 1427:1996 MILD STEEL		<b>NEW METRIC THREAD ROLL PAN TORX</b>  <b>MTMSZPOM</b> Z/P DIN 7500 MILD STEEL





### HEX WASHER HEAD POLE STEP TIMBER



**BW58GLM**  
HDG  
HEC  
CLASS 5.8

### METRIC METAL THREAD PAN COMBI



**MSMSZPCM**  
Z/P  
AS 1427:1996  
MILD STEEL

### METRIC METAL THREAD PAN SLOTTED



**MSBRPPS**  
BRASS  
AS 1427:1996

### METRIC METAL THREAD CSK PHILLIPS



**MSMSZCPM**  
Z/P  
AS 1427:1996  
MILD STEEL

### METRIC METAL THREAD CSK SLOTTED

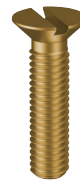

**MSBRPCS**  
BRASS  
AS 1427:1996

## Brass

### FEATURES OF BRASS

- » Durability
- » Can withstand high temperatures
- » Malleable
- » Corrosion resistance
- » Non-sparking
- » Non-magnetic
- » Fire resistance
- » High electrical conductivity



### METRIC HEX NUT

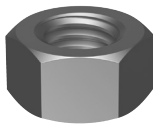

**NH05GCM**  
HDG  
AS 1112.3  
CLASS 5

### METRIC HEX NUT

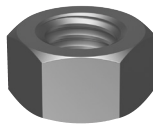

**NH05ZCM**  
Z/P  
AS 1112.3  
CLASS 5

### METRIC HEX NUT

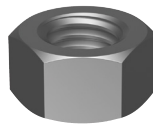

**NH05PCM**  
PLN  
AS 1112.3  
CLASS 5

### BSW HEX NUT

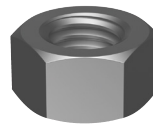

**NHMSGW**  
HDG  
AS 2451

### BSW HEX NUT

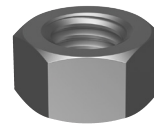

**NHMSZW**  
Z/P  
AS 2451

### BSW HEX NUT

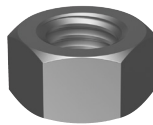

**NHMSPW**  
PLN  
AS 2451

### METRIC LEFT HAND HEX NUT

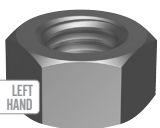

**NH05PDM**  
PLN  
AS 1112.3  
CLASS 5

### NEW METRIC LEFT HAND HEX NUT

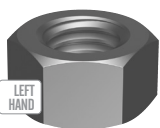

**NH05ZDM**  
Z/P  
AS 1112.3  
CLASS 5

## Left Hand Nut

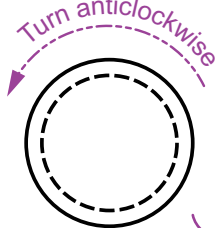

Ideal for applications with rotary parts to counteract rotation.

### ACME 6 TPI HEX NUT

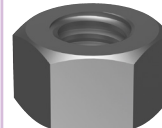

**NHMSPA**  
PLN  
HEC  
CLASS 5

### ACME 6 TPI LEFT HAND HEX NUT



**NHMSPB**  
PLN  
HEC  
CLASS 5

### METRIC HEX NUT



**NHBRPCM**  
BRASS  
AS 1112.3

### UNC HEX NUT



**NHBRPC**  
BRASS  
HEC

### BSW HEX NUT



**NHBRPW**  
BRASS  
AS 2451

### NEW METRIC HEX NUT

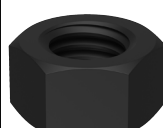

**NH05VCM**  
ZP BLK  
AS 1112.3  
CLASS 5

## Zinc Black Passivate

Acts as a barrier to protect the steel from corrosion. Can be used for electronics and appliances.

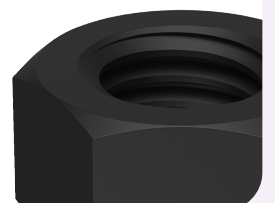



CLASS 4.6

# PURLIN BOLTS

**PURLIN  
HEX FLANGE  
BOLT & NUT**

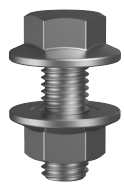

**KBFMSGCM**

HDG  
HEC  
CLASS 4.6

**PURLIN  
HEX FLANGE  
BOLT & NUT**

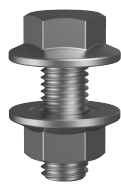

**KBFMSZCM**

Z/P  
HEC  
CLASS 4.6

**PURLIN  
HEX BOLT NUT  
& 2 WASHERS**

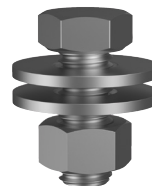

**KBHMSZCM**

Z/P  
HEC  
CLASS 4.6

**FASCIA  
HEX BOLT NUT  
& WASHER**

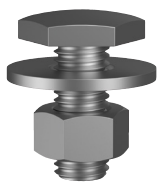

**KBAMSGCM**

HDG  
HEC  
CLASS 4.6

**FASCIA  
HEX BOLT NUT  
& WASHER**

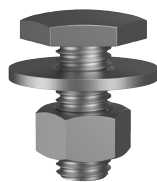

**KBAMSZCM**

Z/P  
HEC  
CLASS 4.6

**PURLIN  
SHOULDER HEX  
BOLT & NUT**

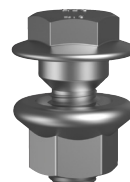

**KBOMSZCM**

Z/P  
HEC  
CLASS 4.6



## NYLOC®

The special nylon insert prevents loosening caused by vibration.

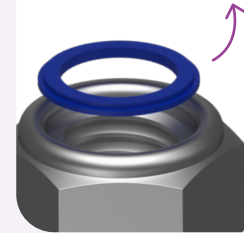

**METRIC THIN HEX LOCK NUT**

**NL05GCM**

HDG  
AS 1112.4  
use with CLASS 5

**NEW UNF HEX THIN LOCK NUT**

**NLG2ZF**

Z/P  
ANSI B18.2.2  
GRADE 2

**NEW METRIC HEX THIN LOCK NUT**

**NLBRNCM**

N/P  
ISO 4035  
BRASS

**METRIC HEX NUT NYLOC**

**NN06GCM**

MGAL  
DIN 985  
CLASS 6

**METRIC HEX NUT NYLOC**

**NN06ZCM**

Z/P  
DIN985  
CLASS 6

**METRIC FINE HEX NUT NYLOC**

**NN06ZFM**

Z/P  
DIN985  
CLASS 6

**METRIC HEX NUT NYLOC**

**NN06YCM**

ZYP  
DIN 985  
CLASS 6

**METRIC FINE HEX NUT NYLOC**

**NN06YFM**

ZYP  
DIN 985  
CLASS 6

**BSW HEX NUT NYLOC**

**NNG2GW**

MGAL  
IFI-100NE  
GRADE 2

**BSW HEX NUT NYLOC**

**NNG2ZW**

Z/P  
IFI-100NE  
GRADE 2

**UNC HEX NUT NYLOC**

**NNG2ZC**

Z/P  
IFI-100NE  
GRADE 2

**UNF HEX NUT NYLOC**

**NNG2ZF**

Z/P  
IFI-100NE  
GRADE 2

**METRIC HEX THIN NUT NYLOC**

**NN05ZTCM**

Z/P  
ISO 10511  
CLASS 04

**UNC HEX THIN NUT NYLOC**

**NNG2ZTC**

Z/P  
ASME B18.16.6  
GRADE 2

**UNF HEX THIN NUT NYLOC**

**NNG2ZTF**

Z/P  
ASME B18.16.6  
GRADE 2

**METRIC SQUARE NUT**

**NQ05GCM**

HDG  
DIN 557  
CLASS 5

**METRIC FINE HEX SLOTTED NUT**

**NO05ZFM**

Z/P  
DIN 935  
CLASS 5

**NEW METRIC HEX SLOTTED NUT**

**NO05PCM**

PLN  
DIN 935  
CLASS 5

**NEW UNF HEX SLOTTED NUT**

**NOG2ZF**

Z/P  
ASME B18.2.2  
GRADE 2

**NEW METRIC HEX K-LOCK NUT**

**NK05ZECM**

Z/P  
DIN 934K  
CLASS 5

## K-Lock Nut

Free spinning tooth-lock washer.

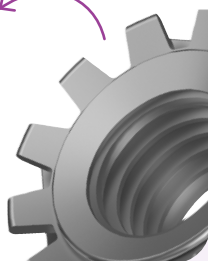

**NEW TEE NUT 4 PRONG**

**NTMSZCM**

Z/P  
HEC  
MILD STEEL

**UNC TEE NUT 4 PRONG**

**NTMSZC**

Z/P  
HEC  
MILD STEEL

## Tee Nut 4 Prong

Prongs to stop the tee nut twisting and moving in the timber.





**NEW METRIC WING NUT**



**NWMSMCM**

MGAL  
UNI 5448  
MILD STEEL

**NEW METRIC WING NUT**



**NWMSZCM**

Z/P  
UNI 5448  
MILD STEEL

## Wing Nut

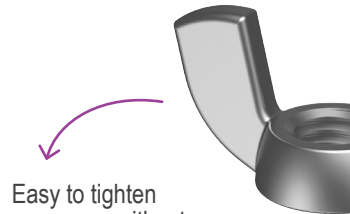

Easy to tighten or remove without the use of a tool.

**METRIC DOME HEX NUT**



**ND05GCM**

HDG  
DIN 1587  
CLASS 5

**METRIC DOME HEX NUT**



**ND05CCM**

CHROME  
DIN 1587  
CLASS 5

**METRIC SHEAR NUT**

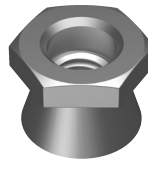

**NS05GCM**

HDG  
HEC  
CLASS 5

**NEW SEMS SPRING & FLAT PAN PHILLIPS**



**LSMSMSZPPM**

Z/P  
JISB 11882017  
MILD STEEL

**NEW SEMS SPRING & FLAT PAN TORX**



**LSMSMSZPOM**

Z/P  
JISB 11882017  
MILD STEEL

## SEMS

(Abbreviation of asSEMBlies — a screw and washer assembly)

DOUBLE WASHER ASSEMBLY SCREWS

- » Saves time
- » Easy installation

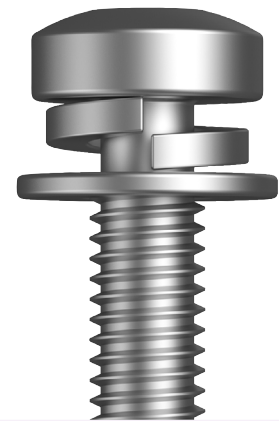

## Spanner Selection Chart - Metric



BOLT SIZE	METRIC SPANNER SIZE (MM)				
	METRIC	AS1110 AS1111 ISO 4014	AS1252.1	DIN931 DIN933 DIN934	DIN6921
M4	7	-	7	-	-
M5	8	-	8	8	7
M6	10	-	10	10	8
M7	11	-	11	11	-
M8	13	-	13	13	10
M10	16	-	17	15	13
M12	18	21	19	16	15
M14	21	-	22	18	18
M16	24	27	24	21	21
M18	27	-	27	-	-
M20	30	32	30	27	-
M22	34	36	32	-	-
M24	36	41	36	-	-
M27	41	46	41	-	-
M30	46	50	46	-	-
M33	50	-	50	-	-
M36	55	60	55	-	-

Find more sizes and Imperial Charts on our website [hobson.com.au](http://hobson.com.au)





MILD STEEL

# PINS

METRIC  
SPLIT PIN



**QPSMSZM**  
Z/P  
HEC  
MILD STEEL

**R CLIP  
HUMPBACK  
PIN**



**QPRMSZM**  
Z/P  
HEC  
MILD STEEL

**NEW SHAFT  
LOCKING PIN  
D TYPE**

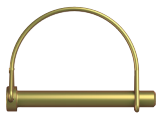

**QPHMSYDM**  
ZYP  
HEC  
MILD STEEL

**LINCH PIN**



**QPLMSYM**  
ZYP  
HEC  
MILD STEEL

**NEW SHAFT  
LOCKING PIN  
SQUARE**



**QPHMSYQM**  
ZYP  
HEC  
MILD STEEL

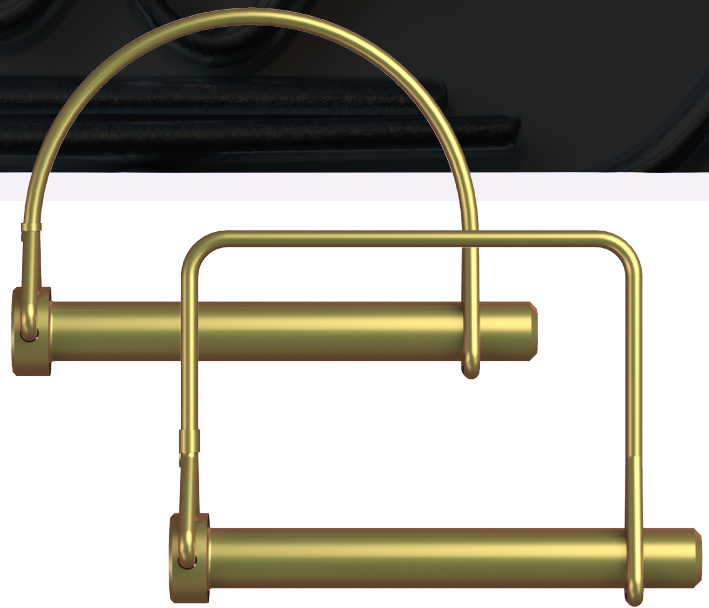

## Shaft Locking Pins

Anti-vibration  
solution to secure  
the end of a shaft,  
for round and  
square tubes.