

STD WT LONG RADIUS ELBOWS 180°

BUTTWELD

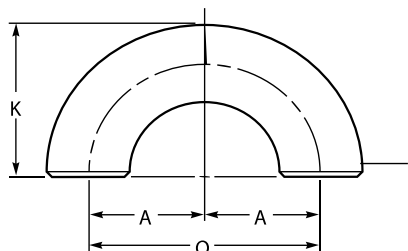

PART NO. 180°	DN SIZE (mm)	OD SIZE (mm)	WALL (mm)	A (mm)	O (mm)	K (mm)	WEIGHT (kg)
ESL180025	25	33.4	3.38	38	76	56	0.3
ESL180032	32	42.2	3.56	48	95	70	0.51
ESL180040	40	48.3	3.68	57	114	83	0.73
ESL180050	50	60.3	3.91	76	152	106	1.3
ESL180065	65	73	5.16	95	190	132	2.58
ESL180080	80	88.9	5.49	114	229	159	4.04
ESL180100	100	114.3	6.02	152	305	210	7.68

STD WT SHORT RADIUS ELBOWS 90°

BUTTWELD

PART NO. 90°	DN SIZE (mm)	OD SIZE (mm)	WALL (mm)	A (mm)	WEIGHT (kg)
ESS90025	25	33.4	3.38	25	0.1
ESS90032	32	42.2	3.56	32	0.17
ESS90040	40	48.3	3.68	38	0.24
ESS90050	50	60.3	3.91	51	0.44
ESS90065	65	73	5.16	64	0.86
ESS90080	80	88.9	5.49	76	1.35
ESS90100	100	114.3	6.02	102	2.56
ESS90125	125	141.3	6.55	127	4.34
ESS90150	150	168.3	7.11	152	6.76
ESS90200	200	219.1	8.18	203	13.6
ESS90250	250	273	9.27	254	24
ESS90300	300	323.8	9.53	305	35.3
ESS90350	350	355.6	9.53	356	45.4
ESS90400	400	406.4	9.53	406	59.4
ESS90450	450	457	9.53	457	75.4
ESS90500	500	508	9.53	508	96
ESS90600	600	559	9.53	610	140

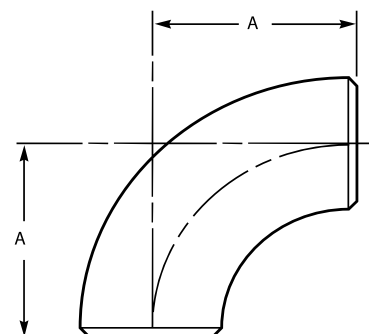

MATERIALS

ASTM A234 WPB

Carbon Steel Seamless

SPECIFICATIONS

Pressure Rating

As per ASME B31.3 (refer pg196)

STANDARD

Dimensional

ASME B16.9

STD WT LONG RADIUS ELBOWS

BUTTWELD

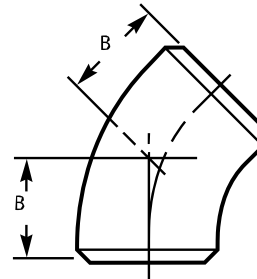
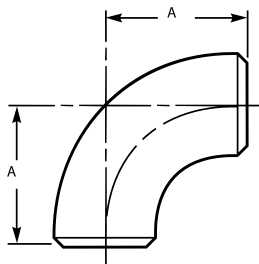

PART NO. 90°	DN SIZE (mm)	OD SIZE (mm)	WALL (mm)	A (mm)	WEIGHT (kg)
ESL90015	15	21.3	2.77	38	0.08
ESL90020	20	26.7	2.87	38	0.08
ESL90025	25	33.4	3.38	38	0.15
ESL90032	32	42.2	3.56	48	0.26
ESL90040	40	48.3	3.68	57	0.37
ESL90050	50	60.3	3.91	76	0.65
ESL90065	65	73	5.16	95	1.29
ESL90080	80	88.9	5.49	114	2.02
ESL90090	90	101.6	4	133	2.84
ESL90100	100	114.3	6.02	152	3.84
ESL90125	125	141.3	6.55	190	6.51
ESL90150	150	168.3	7.11	229	10.1
ESL90200	200	219.1	8.18	305	20.3
ESL90250	250	273	9.27	381	36
ESL90300	300	323.8	9.53	457	53
ESL90350	350	355.6	9.53	533	68
ESL90400	400	406.4	9.53	610	89.2
ESL90450	450	457	9.53	686	113
ESL90500	500	508	9.53	762	140
ESL90600	600	559	9.53	838	202

PART NO. 90°	DN SIZE (mm)	OD SIZE (mm)	WALL (mm)	B (mm)	WEIGHT (kg)
ESL45015	15	21.3	2.77	16	0.04
ESL45020	20	26.7	2.87	19	0.04
ESL45025	25	33.4	3.38	22	0.08
ESL45032	32	42.2	3.56	25	0.13
ESL45040	40	48.3	3.68	29	0.19
ESL45050	50	60.3	3.91	35	0.33
ESL45065	65	73	5.16	44	0.65
ESL45080	80	88.9	5.49	51	1.01
ESL45090	90	101.6	4	79	1.42
ESL45100	100	114.3	6.02	64	1.92
ESL45125	125	141.3	6.55	79	3.26
ESL45150	150	168.3	7.11	95	5.05
ESL45200	200	219.1	8.18	127	10.2
ESL45250	250	273	9.27	159	18
ESL45300	300	323.8	9.53	190	26.5
ESL45350	350	355.6	9.53	222	34
ESL45400	400	406.4	9.53	254	44.6
ESL45450	450	457	9.53	286	56.5
ESL45500	500	508	9.53	318	70
ESL45600	600	559	9.53	343	101

MATERIALS
ASTM A234 WPB
Carbon Steel Seamless

SPECIFICATIONS
Pressure Rating
As per ASME B31.3 (refer pg196)

STANDARD
Dimensional
ASME B16.9