

STANDARD WEIGHT REDUCING TEE

BUTTWELD FITTINGS

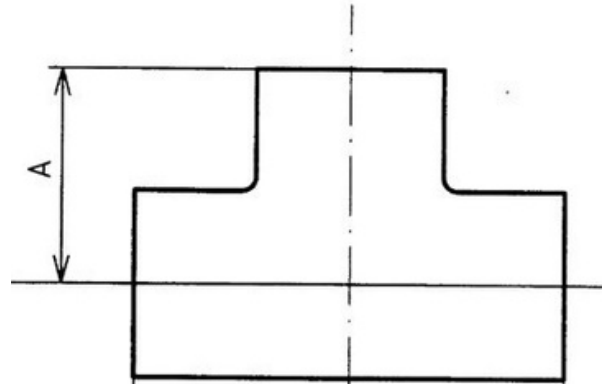

PART NO.	SIZE (MM)	SIZE (INCH)
TS5025	50 X 25	2 X 1
TS6550	65 X 50	2-1/2 X 2
TS8050	80 X 50	3 X 2
TS10080	100 X 80	4 X 3
TS150100	150 X 100	6 X 4
TS200150	200 X 150	8 X 6

MATERIALS

Carbon Steel	0.25% Max C
Galvanising	HDG
Zinc Plating	EZP

SPECIFICATIONS

Thread
BSP to ISO 7-1
Cold Working Pressure
5000 kPa

STANDARD

Manufacturing
EN10241-2000