



PRODUCT DATA

E-Coat Black Super Flat Head Self-drilling Screw

Metal to metal fixing - Self Drilling Screw (SDS) #12-24

Applications	
<ul style="list-style-type: none"> Prefabricated steel wall frames 	

Material	 1022 C1022 Hardened
-----------------	---

Finish	 E-Coat Black
---------------	--

Pullout Values				
Plate (Purlin)	Metal Plate Thickness (mm)	¹ Mean Load (N)	² Characteristic Load (N)	³ Working Load (N)
G2	0.5	550	450	200
G2	0.7	800	650	250
G2	1.1	1350	1250	500
G550	1.5	3350	3000	1200

Drill Point Test and Mechanical Properties						
Plate (Purlin)	Metal Plate Thickness (mm)	Load (kg)	Drill Speed (RPM)	Drill Time (Max. individual) Seconds	Drill Time (Max. average) Seconds	Torsional Strength (Nm)
G550	1.5	18	2200	3.5	3.0	11.3

Super Flat Head



Features

- Self-drilling tip. No pre-punched holes required
- E-coat reduces friction during installation and provides moderate corrosion protection.

Note: 1000N = 1kN

¹ Mean Load/Strength is the average ultimate strength of samples tested.

² Characteristic Load/Strength: 95% of these screws are expected to have a strength greater than the loads shown.

³ Working Load is the governing minimum allowable load obtained by comparing relevant concrete and steel working loads. Factor of Safety (FOS=2.5 for steel, FOS=2.5 for timber and FOS=3.0 for concrete) are already included.

All values are obtained under laboratory conditions using DRILLX product. Safety factors should be considered for design purposes. Actual pullout loads may differ slightly depending on certain properties of the base material.

Disclaimer: While every reasonable effort has been made to ensure that this document is correct at the time of printing, Hobson Engineering, its agencies and employees, disclaim any and all liability to any person in respect of anything or the consequences of anything done or omitted to be done in reliance upon the whole or any part of this document.



Bolt Tension | Anti-Vibration | Product Reliability | Traceability

hobson.com.au **QUALITY FASTENERS SINCE 1935**

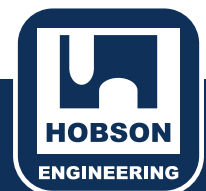



PRODUCT DATA

E-Coat Black Super Flat Head Self-drilling Screw

Part	QFind	Gauge	TPI	Length	Thread Length	Drill Point Length	Head Height	Head ø	Drive Size	Pack Qty
				L (mm)	T (mm)	DP (mm)	H (mm)	D (mm)	PH	
T9PMKNP1224018	QB76	12	24	18	10	6	1.5	9.5	#2	1000

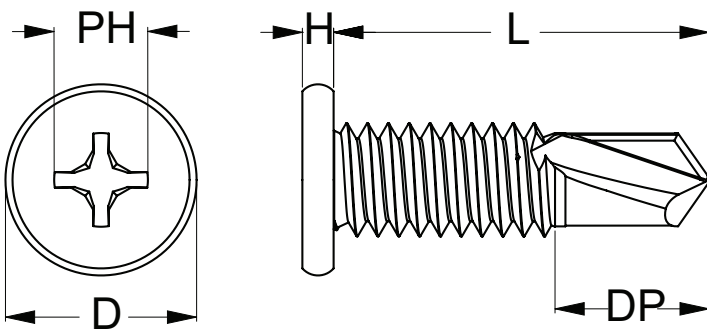

Installation

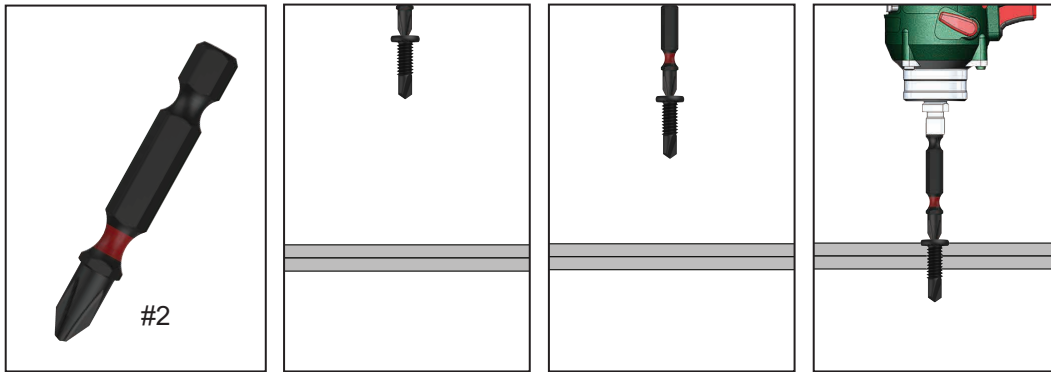

Recommended #2 Phillips Drive Bit:

Part	QFind	Length (mm)
TXDIPPHS20050	B316	50
TXDIPPHS20075	BA27	75
TXDIPPHS20100	B326	100
TXDIPPHS20150	B331	150

Installation Guide

1. Use a cordless screw driver set between 2,200-3,000 RPM. Fit the Phillips Drive Bit over the screw and place at the fastening position.
2. Apply consistently firm pressure to the screw driver while the screw is drilling.
3. Care should be taken not to overtighten the screw.

*Installation with impact drivers not recommended.

Disclaimer: While every reasonable effort has been made to ensure that this document is correct at the time of printing, Hobson Engineering, its agencies and employees, disclaim any and all liability to any person in respect of anything or the consequences of anything done or omitted to be done in reliance upon the whole or any part of this document.

Bolt Tension | Anti-Vibration | Product Reliability | Traceability

hobson.com.au **QUALITY FASTENERS SINCE 1935**

