

# DID YOU KNOW?



about our... **SEMS Hex Bolt High Tensile 8.8 and Flat Washer**

## SEMS HEX BOLT FLAT WASHER (ASSEMBLED) ZINC PLATED / AS1110.1 / CLASS 8.8

**NEW  
PRODUCT**

Part	Size	Length (mm)	Thread Length	Across Flats (mm)	Washer Outside Diameter (mm)	Washer Thickness (mm)	Pack Qty
LRBH88ZCM100025	M10	25	Full	16	27	2.2	100

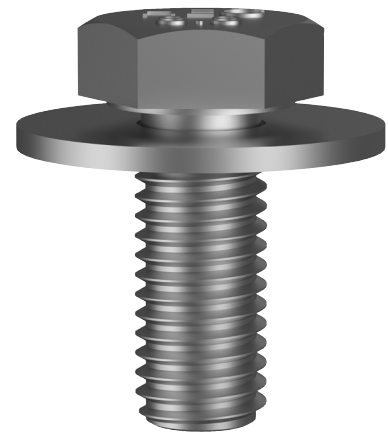
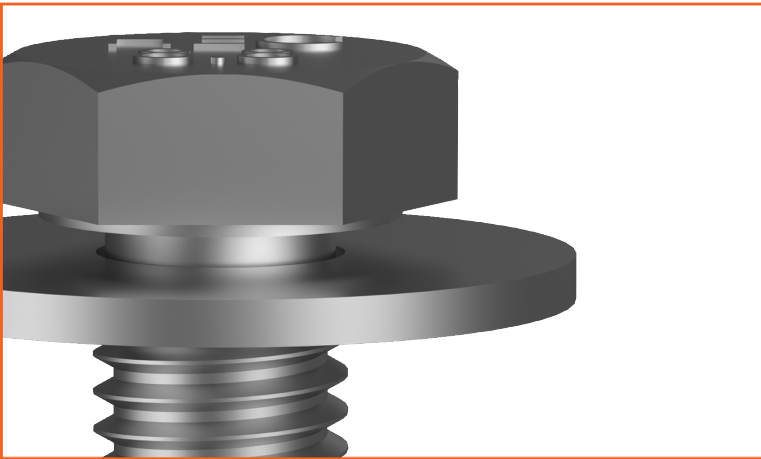

- Features a captive washer for fast installation.

### Features

- Permanently attached washer (captive washer).
- Save time on assembly and installation.
- Ensures bolt is installed with washer under the head.
- Large OD washer.

### Flat Washer

- Distribute the under-head bearing pressure evenly over the mating surface.
- Helps prevent damage to the surface of the object being fastened.

### Applications

- Bolting application where a washer is required – the pre assembly of the washer creates a time and labour saving (and therefore cost saving) at time of installation.
- Commonly used in manufacturing assembly lines where time and labour savings are preferred to the cost of the fastener.

**SEMS is an abbreviation of asSEMBlies, a screw and washer assembly.**



### DOWNLOAD:

LRBH88ZCM100025 has a Test Certificate and/or Report available

**ONLINE**