

ELBOW 90° MF, HEX NIPPLE & HEX PLUG

HIGH PRESSURE - CLASS 3000LB

PART NO. HEX NIPPLE	DN SIZE (mm)	A (mm)	W (mm)	E (mm)	B (mm)	C (mm)	WEIGHT (kg)
HPHN006	6	11	26	10	5	6	0.01
HPHN008	8	15	36	15	8	6	0.03
HPHN010	10	18	40	16	11	8	0.04
HPHN015	15	22	48	20	14	8	0.08
HPHN020	20	27	52	21	19	10	0.12
HPHN025	25	35	60	25	24	10	0.24
HPHN032	32	41	66	26	30	14	0.39
HPHN040	40	50	68	26	38	16	0.38
HPHN050	50	62	71	27	49	17	1
HPHN065	65	80	107	44	58	19	1.29
HPHN080	80	95	109	44	71	21	1.87
HPHN0100	100	125	125	50	95	25	3.37

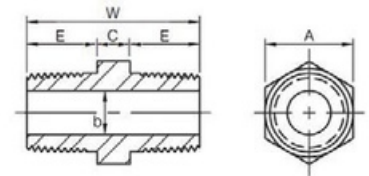

HPCN SIZE BN = CROSS OVER NIPPLE NPT/BSPT

MATERIALS
Forged Carbon Steel
Also available in Hot Dipped Gal

SPECIFICATIONS
Thread
BSPT & NPT
Hex Nipples available in crossover configuration

STANDARD
Material
ASTM A105
Dimensional
ASME B16.11 & BS3799