

ELBOW 45°, 90° & EQUAL TEE

HIGH PRESSURE - CLASS 3000LB

PART NO. ELBOW 90°	DN SIZE (mm)	B (mm)	L2 (mm)	A (mm)	G (mm)	H (mm)	WEIGHT (kg)
HPEFF008	8	8.1	10.2	25	3.3	25	0.15
HPEFF010	10	9.1	10.4	28	3.51	33	0.29
HPEFF015	15	10.9	13.6	33	4.09	38	0.42
HPEFF020	20	12.7	13.9	38	4.32	46	0.64
HPEFF025	25	14.7	17.3	44	4.98	56	1.14
HPEFF032	32	17	18	51	5.28	62	1.42
HPEFF040	40	17.8	18.4	60	5.56	75	2.63
HPEFF050	50	19	19.2	64	7.14	84	2.92
HPEFF065	65	23.6	28.9	83	7.65	102	5.99
HPEFF080	80	25.9	30.5	95	8.84	121	8.88
HPEFF0100	100	27.7	33	114	11.18	152	14.85

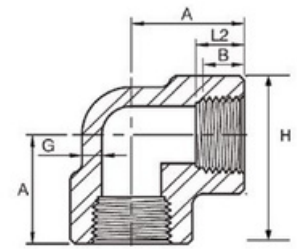

MATERIALS
Forged Carbon Steel
Also available in Hot Dipped Gal

SPECIFICATIONS
Thread
BSPT & NPT

STANDARD
Material
ASTM A105
Dimensional
ASME B16.11