

ELBOW 45°, 90° & EQUAL TEE

HIGH PRESSURE - CLASS 3000LB

PART NO. ELBOW 45°	DN SIZE (mm)	B (mm)	L2 (mm)	C (mm)	G (mm)	H (mm)	WEIGHT (kg)
HPE45008	8	8.1	10.2	19	3.3	25	0.12
HPE45010	10	9.1	10.4	22	3.51	33	0.24
HPE45015	15	10.9	13.6	25	4.09	38	0.37
HPE45020	20	12.7	13.9	28	4.32	46	0.56
HPE45025	25	14.7	17.3	33	4.98	56	0.94
HPE45032	32	17	18	35	5.28	62	1.03
HPE45040	40	17.8	18.4	43	5.56	75	2.05
HPE45050	50	19	19.2	44	7.14	84	2.23
HPE45065	65	23.6	28.9	52	7.65	102	4.19
HPE45080	80	25.9	30.5	64	8.84	121	6.15
HPE450100	100	27.7	33	79	11.18	152	11.67

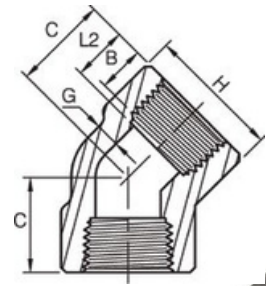

MATERIALS
Forged Carbon Steel
Also available in Hot Dipped Gal

SPECIFICATIONS
Thread
BSPT & NPT

STANDARD
Material
ASTM A105
Dimensional
ASME B16.11