

XS LONG & SHORT RADIUS ELBOWS

BUTTWELD

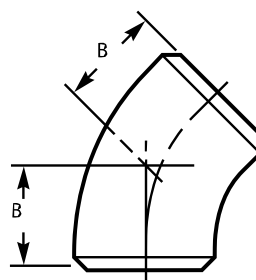
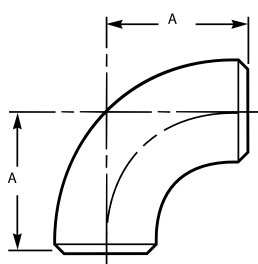

PART NO. 90°	DN SIZE (mm)	OD SIZE (mm)	WALL (mm)	A (mm)	WEIGHT (kg)
EXSL90025	25	33.4	4.55	38	0.2
EXSL90032	32	42.2	4.85	48	0.34
EXSL90040	40	48.3	5.08	57	0.49
EXSL90050	50	60.3	5.54	76	0.9
EXSL90065	65	73	7.01	95	1.7
EXSL90080	80	88.9	7.62	114	2.74
EXSL90100	100	114.3	8.56	152	5.34
EXSL90125	125	141.3	9.53	190	9.25
EXSL90150	150	168.3	10.97	229	15.3
EXSL90200	200	219.1	12.7	305	30.9
EXSL90250	250	273	12.7	381	48.8
EXSL90300	300	323.8	12.7	457	69.9

PART NO. 45°	DN SIZE (mm)	OD SIZE (mm)	WALL (mm)	B (mm)	WEIGHT (kg)
EXSL45025	25	33.4	4.55	22	0.1
EXSL45032	32	42.2	4.85	25	0.17
EXSL45040	40	48.3	5.08	29	0.25
EXSL45050	50	60.3	5.54	35	0.45
EXSL45065	65	73	7.01	44	0.85
EXSL45080	80	88.9	7.62	51	1.37
EXSL45100	100	114.3	8.56	64	2.67
EXSL45125	125	141.3	9.53	79	4.62
EXSL45150	150	168.3	10.97	95	7.65
EXSL45200	200	219.1	12.70	127	15.4
EXSL45250	250	273	12.70	159	24.4
EXSL45300	300	323.8	12.70	190	35

PART NO. 90°	DN SIZE (mm)	OD SIZE (mm)	WALL (mm)	A (mm)	WEIGHT (kg)
EXSS90040	40	48.3	5.08	38	0.33
EXSS90050	50	60.3	5.54	51	0.6
EXSS90065	65	73	7.01	64	1.14
EXSS90080	80	88.9	7.62	76	1.83
EXSS90100	100	114.3	8.56	102	3.56
EXSS90150	150	168.3	10.97	152	10.2
EXSS90200	200	219.1	12.7	203	-
EXSS90250	250	273	12.7	254	-
EXSS90300	300	323.8	12.7	305	-

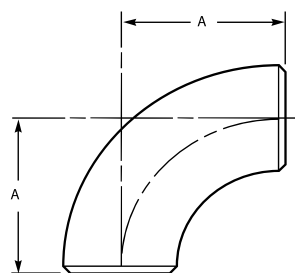

MATERIALS

ASTM A234 WPB
Carbon Steel Seamless

SPECIFICATIONS

Pressure Rating
As per ASME B31.3 (refer pg196)

STANDARD

Dimensional
ASME B16.9